



QUOTATION NOTICE
FOR
SUPPLY & COMMISSIONING SUPPORT OF FIRE ALARM
SYSTEM EQUIPMENT FOR WATER METRO VESSELS

Quotation Notice No.: KWML/PROC/TENDER/2026-27/14

Quotation Notice Date: 04.07.2026

Last Date of Bid Submission: 13.07.2026 @ 15.00 hrs

KOCHI WATER METRO LIMITED

(A JOINT VENTURE COMPANY OF GOVT OF KERALA AND KOCHI METRO RAIL LIMITED)

4th Floor, JLN Stadium Metro Station, Kaloor, Kochi – 682 017

Phone: +91 (484) 284 6700



Quotation Notice

KWML/PROC/TENDER/2026-27/14

04.07.2026

Kochi Water Metro Ltd (KWML) invites quotation for **“Supply & Commissioning Support of Fire Alarm System Equipment for Water Metro Vessels”** as per the details below.

I] Item Description & Scope of Work

Fire Alarm System Equipment: AUTRONICA

SL No	Description of Items	Quantity	Unit
A1	Control Panel-AUTROPRIME BC-250 W BS-210	1	No
A2	MCP Weather Proof (BF-510WP-H) with Gland Nut M20 x 1.5 Polymide (2)	1	No
A3	Glands-Euro-Top M20L Gland 6-12 Grey	2	Nos
A4	MCP W-Manual Call Point Normal Current (BF-300V2)	1	No
A5	Detector-V-430/BH300	1	No
A6	Detector Base	1	No
A7	Detector-V-430/BH300	1	No
A8	Detector Base	1	No
A9	Conduit Box	1	No
A10	Detector-V-430/BD300	1	No
A11	Detector Base	1	No
A12	Conduit Box – BWP-100	1	No
A13	Sounder/flasher-Alarm Sounder Flasher Red - Flashni	1	No

SI No	Description of Work	Quantity	Unit
1	Commissioning Support – Online or Offline	1	Day

Detailed Technical Specification is attached as Annexure I.

III] Key Details: -

1)	Email id for receiving queries and clarification	procurement@watermetro.co.in
2)	Contact Person Details	Manager (Procurement - KWML) Ph: 9744139148
3)	EMD & Tender fee	Nil
4)	Type of Tender	Single Bid
5)	Last date and time of submission	13.07.2026 @ 15.00 hrs
6)	Time and date of opening	13.07.2026 @ 15.30 hrs
7)	The documents to be submitted along with bid	<ul style="list-style-type: none"> a) Duly filled form Appendix 1 b) PAN Card copy c) GST registration certificate d) Cancelled cheque copy e) Letter of Proposal submission as per the format enclosed in Appendix 2 f) Schedule of compliance as per the format enclosed in Appendix 3 g) Statement of Deviation as per the format enclosed in Appendix 4 h) Financial bid as per the format enclosed in Appendix 5. i) In case of MSME, Udyam Certificate to be submitted.
8)	Address of receipt of Sealed envelope by specifying RFQ title & number on the envelope.	Manager (Procurement) Kochi Water Metro Limited, First Floor, OPERATION CONTROL CENTRE(OCC) BUILDING, VYTTILA, KOCHI, KERALA-682019.
9)	Opening location of Quotation	Same location as above
10)	Delivery Period	All the items must be delivered within 5 weeks from the date of issuance of Letter of Award (LOA).
11)	Delivery Address	High Court Jn Water Metro Terminal Kochi Water Metro Ltd Marine Drive, Ernakulam-682031 Cochin, Kerala.

12)	Award criteria	<p>The LOA/PO will be awarded based on the technically accepted lowest total cost(L1) including all taxes and GST post correction of arithmetic errors if any.</p> <p>Unconditional acceptance of LOA/WO must be furnished within 3 days of issuance of same.</p>
13)	Warranty	Minimum One (01) Year from the date of invoice.
14)	Retention amount:	5% of the total order value retained will be released after warranty period, after adjusting the late performance debit charges.
15)	Payment Terms:	<p><u>Goods</u></p> <p>The payment shall be made on supply & acceptance of full quantity after all statutory deductions and retention if any will be made against submission of the following;</p> <ul style="list-style-type: none"> a) Tax Invoice b) Warranty certificate. <p><u>Service</u></p> <p>Payment for commissioning support shall be released against successful completion after all statutory deductions, if any, against the submission of Tax Invoice duly certified by User Dept.</p>
16)	Repeat Order	<p>The Contract will have a Repeat Order Clause, wherein KWML can order under the Contract within six months from the date of completion of supply under the original PO/LOA.</p> <p>The Repeat Order will have rates on not exceeding basis while the terms and conditions will remain unchanged. It will be entirely the discretion of KWML to exercise the Repeat order or not.</p>
17)	Variation clause	The quantity mentioned in the BOQ is indicative. The total quoted contract value may vary +/- 25% to the next rounded whole number of the ordered quantity. The contractor shall submit invoice for the actual quantity of material delivered, based on the certification from KWML representative against the unit rate quoted.

18) While submitting the quotation, the bidder will be deemed to have read, understood and accepted all the terms and conditions stated in this document and its addendum/corrigendum if any and no change, what so ever desired, will be entertained by KWML.

- 19) Further, corrigendum/addendum, if any, issued to the Tender /bid document, shall only be made available at the website.
- 20) The bid shall be submitted in a single sealed envelope. The RFQ Name and number shall be super scribed on top of the envelope.
- 21) Bid validity: 90 days from the date of Bid Closing date.
- 22) The Bid of the bidder which is responsive, complete and in accordance with the Tender document will be considered for evaluation. After completing the evaluation, LOA/PO will be placed to the technically qualified least total cost, including all taxes, among the offers received. If one or more bidder has quoted the same unit rate for the goods, sealed counter offer shall be sought from those bidders for placing P.O to the least offered bidder.
- 23) Whenever the tenderer deviates from the provisions of a clause /sub-clause, they shall furnish detailed justification for the same in the Statement of Deviations in the format attached in Appendix - 3.
- 24) The whole contract is to be executed in the most approved, substantial and precise workmanship manner, to the entire satisfaction of the Purchaser or his nominee, who, both personally and may his deputies shall have full power, at every stage of progress, to inspect the material at such times as he may deem to fit or to reject any of the material which he may disapprove.
- 25) KWML does not bind itself to accept the lowest tender or to assign any reason for non-acceptance of the same.
- 26) Invoice: Invoice should be submitted in duplicate, after completion of supply against supply order. Invoice should contain bank details, name of the bank, Branch, IFSC code, PAN details, HSN/SAC code, Supplier's GST no. and KWML GST No. 32AAICK8891J1ZZ and must be addressed to Chief Operating Officer (Water Metro), 4th Floor, JLN Metro Station, Kaloor, Ernakulam, Kerala-682017.
- 27) Taxes and Duties: -
 - a) Participants should quote the price for door delivery including Transit insurance, freight charges, loading & unloading charges and indicating separately the basic price and GST rate applicable for each unit tendered along with the HSN/SAC code and if GST exemption is there, appropriate exemption notification document should be submitted. All taxes will be paid at actuals based on prevailing rates.
 - b) Transportation, packing, forwarding and other charges if any, shall also be included in the quoted price.
 - c) Contract amount will be the total price quoted inclusive of all taxes and including GST.
 - d) The GST amount shall be calculated as per the percentage quoted in the financial bid.
 - e) In case any bidders make arithmetical errors or quote with a different percentage or omit to quote, the same will be corrected as per the percentage applicable against the quoted HSN/SAC in the financial bid. In case no HSN/SAC is provided the quoted rate shall be deemed as inclusive of applicable GST. If the total corrected value exceeds the total quoted value in the financial bid, then the base price will be adjusted so as to maintain the originally quoted amount inclusive of taxes.
 - f) The tax liability as per GST Act rests with the contractor, ambiguity if any regarding the percentage for that particular work or Services Accounting Code (SAC)/HSN etc. shall be cleared before offering of rates.
 - g) Any liability on account of wrong classification of goods or services for arriving at taxes will be on the bidder.

- h) Lowest offer will be decided based on the overall lowest amount calculated with the basic price along with GST.
- i) Invoice as per GST Act should be furnished prior to every running account/final bills.
- j) GST at actuals shall be paid on the quoted/corrected base value as per GST law in India after submission of appropriate GST invoices with GSTIN of the bidder and GSTIN of Kochi Water Metro Ltd - 32AAICK8891J1ZZ.
- k) The Contractor shall bear and pay all taxes (other than GST of the goods and services rendered to KWML), duties, levies and charges assessed on the Contractor, its Subcontractors or their employees by all municipal, state or national government authorities in connection with the facilities in and outside India.
- l) In event of exemption or reduction of any form of Tax being granted by the Government in respect of the works, the benefit of the same shall be passed on to the purchaser.
- m) All statutory levies (except GST) applicable to this contract shall be payable by the contractor and KWML will not entertain any claim whatsoever in this respect other than GST. GST will be paid extra at the applicable rate on the applicable value, as per GST law in India, after submission of appropriate GST invoices by the contractor to KWML.
- n) Under GST law the contractor shall also comply regarding filing of all the returns to the GST network/government departments within the stipulated time, every month or such other period as required by the Government. If the contractor does not comply with any of the GST laws and procedures and if KWML incurs any liability on this account or does not get the input credit from the GST Network/Government as goods and/or service receiver due to the contractor's failure to comply with the procedures of filing / uploading of data/submissions of documents etc. in time then all such liability including the input credit of the GST lost by KWML and the penalties and interest incurred by KWML would be the liability of the contractor and the same shall be recovered either by recovery from security deposits / any other amount payable by the contractor to KWML or through direct payment. The contractor shall submit the copy of latest filed return - GSTR1 along with the invoice.

28) Quoted price:

- a) If there is a discrepancy between the unit price and the line-item total that is obtained by multiplying the unit price by the quantity, the unit price shall prevail and the line-item total shall be corrected, unless in the opinion of the Company there is an obvious misplacement of the decimal point in the unit price, in which case the line-item total as quoted shall govern and the unit price shall be corrected;
- b) If there is an error in a total corresponding to the addition or subtraction of subtotals, the subtotals shall prevail and the total shall be corrected; and
- c) If there is a discrepancy between words and figures, the amount in words shall prevail, unless the amount expressed in words is related to an arithmetic error, in which case the amount in figures shall prevail subject to (a) and (b) above.
- d) Tenderers shall be requested to accept correction of arithmetical errors. Failure to accept the correction shall result in the rejection of the Tender and forfeiture of bid security
- e) The prices quoted should be firm and not subject to any variation, unless specified in the tender documents. Any deviation in this aspect may make the offer liable to be ignored.

- 29) The offers received through telex/tele-fax/e-mail will not be accepted by KWML under any circumstances.
- 30) If the date specified for opening of quotation happens to be a holiday for KWML, it will be opened next working day at the designated time.
- 31) KWML shall not be responsible for any delay/loss or non-receipt of quotation by post/courier service. Late quotation (received after date and time of submission of bid) shall not be accepted under any circumstances.
- 32) KWML reserves the right to accept or reject any or all proposals without assigning any reasons. No bidder shall have any cause of action or claim against the KWML for rejection of his proposal.
- 33) Quotation, in which any of the particulars and prescribed information are missing or are incomplete, in any respect and or prescribed conditions are not fulfilled, shall be considered as non-responsive and liable to be rejected.
- 34) No advance payment can be made.
- 35) Only one quote to be submitted by one bidder
- 36) All disputes shall be settled in a court of law having jurisdiction at Kochi.
- 37) Bidder shall submit sample of material confirming to the technical specifications if requested by KWML.
- 38) Vendor whose aggregate turnover in any preceding financial year (starting from 2017-18) exceeds Rs. 5 crores, has to mandatorily generate E-invoice. Hence, invoices submitted by vendors should be E invoices (i.e, Invoices electronically uploaded and authenticated with a unique IRN and digitally signed QR code).In case E invoicing is not applicable, E - Invoice exemption declaration form shall be submitted by vendor along with invoice. If the above-mentioned form cannot be filed due to non-enablement of e-invoicing as turnover is less than 5 Cr., proof of the same shall be submitted along with invoice.

39) Late delivery penalty and liquidated damages

For Delivery: If the contractor fails to complete the delivery within the stipulated time in the order and/or contract, the contractor shall pay KWML in terms of late delivery fee of 0.5% of value of delayed goods per week of delay subject to maximum 10% of the value of contract. For avoidance of doubt, the L.D will be calculated on pro rata basis for the no. of days of delay. Any delay happened from KWML will be excluded for the calculation of LD.

The contractor shall attend the fault reported on inspection within 3 days from the time of notification by KWML and shall be rectified/replaced the defective parts within 7 days after attending the same. If the contractor fails to rectify/replace the faults within 7 days after attending, the contractor shall pay a liquidated damage fee/ performance debit charges of 0.5% of the retention amount furnished for each 1 day of delay subject to maximum of the retention amount.

- 40) Notification of delivery and dispatch with regard to each and every consignment shall be made to the Purchaser immediately on despatch and delivery. The tracking number of transport mode along with necessary details for tracking of the dispatched material needs to be communicated to the purchaser on every dispatch.
- 41) The Contractor shall full indemnify for all claims damages, expenses and related liabilities.

42) FORCE MAJEURE

In the event of any unforeseen event during the currency of the Contract, such as earthquake, war, fires, floods, or acts of God, as a result of which, either party (purchaser/ contractor) is prevented or hindered in performing any of its obligations under the contract, then it shall within a week from the commencement thereof, notify the same in writing to the other party with reasonable evidence thereof. If the force majeure condition(s) mentioned above be in force for a period of 90 days or more at any time, the either party shall have the option to terminate the contract on expiry of 90 days of commencement of such force majeure by giving 14 days' notice to the other party in writing. In case of such termination, no damages shall be claimed by either party against the other, save and except those which had occurred under any other clause of this contract prior to such termination.

43) CONSIGNEE'S RIGHT OF REJECT

Notwithstanding any approval which the Inspecting officer may have given in respect of the stores or any goods or other particulars or the work or workmanship involved in the performance of contract (whether with or without any test carried out by the Contractor or the Inspecting officer or under the direction of the inspecting Officer) and notwithstanding delivery of the stores /completion of work where so provided to the interim consignee , it shall be lawful for the consignee, on behalf of the Purchaser , to reject the stores/work or any part, portion of the consignment thereof within 45 days after actual delivery/completion thereof to him at the place or destination specified in the contract if such stores/ work or part , portion of consignment thereof is not in all respects in conformity with the terms and conditions of contract whether on account of any loss , deterioration or damage before dispatch or delivery or during transit or otherwise howsoever.

44) REJECTION CRITERIA

If on inspection of the material at site, are found to be not matching the requirement of the purchaser as mentioned in the tender document and are being rejected by the inspecting officer/ team of KWML or its representatives, the Contractor would be required to make satisfactory supplies of brand new and unused material meeting the requirement as mentioned in the tender document within the stipulated period of delivery.

- (a) On rejection of any Material submitted for inspection at a place other than the premises of the Contractor, such stores shall be removed by the Contractor at his own cost subject as herein after stipulated, within 10 days of the date of intimation in writing of such rejection.
- (b) All rejected material shall in any event and circumstances remain and always are at the risk of the Contractor immediately on such rejection. If such material is not removed by the Contractor within the period aforementioned, the Inspecting officer/KWML representatives or its authorised personnel may remove the rejected material. The Purchaser shall in addition, be entitled to recover from the Contractor the handling and storage charges on the rejected material after expiry of the time limit mentioned above.



APPENDIX 1
COMPANY PROFILE

No.	DETAILS	
1	Title Company/Firm/Individual/HUF/Partnership /others (others please specify) (Attach certificates wherever necessary)	
2	Name of Bidder (with city and postal code)	
3	Address with telephone, e-mail, fax number & the name(s) of the contact person(s) (If address to place order is different from registration address, please mention both)	
4	GST ID State of registration	
5	PAN DETAILS	
6	BANK DETAILS Name of Bank Name of Branch IFSC Code Account Number Address of Bank	

Authorized signatory

Name:

Designation

Signature & stamp



APPENDIX 2

LETTER OF PROPOSAL SUBMISSION

Bid for “Supply & Commissioning Support of Fire Alarm System Equipment for Water Metro Vessels “

To,
Manager (Procurement)
Kochi Water Metro Ltd.

Reference: RFQ for “Supply & Commissioning Support of Fire Alarm System Equipment for Water Metro Vessels”

Dear Sir,

We hereby submit our Bid for “Supply & Commissioning Support of Fire Alarm System Equipment for Water Metro Vessels”

DECLARATION: I/We hereby confirm having read and understood the RFQ and the requirements of supply/work under this tender. The information furnished by us is true to the best of our knowledge and belief and nothing has been concealed there from. I/We agree to abide by all the terms and conditions of the RFQ document (and corrigendum/addendum if any), in case the job is awarded to me/us.

Place :

Date :

Name & Designation of Authorized Person

Signature:

Stamp



Appendix - 3

SCHEDULE OF COMPLIANCE WITH SCOPE OF WORK

Sl. No	Specification	Complied Yes/No	Remarks

NB: Leaving this appendix blank will be treated as Compliance with scope of work and technical specifications

Place :

Date :

Name & Designation of Authorized Person

Signature:

Stamp



Appendix - 4

STATEMENT OF DEVIATION FROM RFQ TERMS AND CONDITIONS

RFQ Clause No	DEVIATION IF ANY	REMARKS

NB: Leaving this appendix blank will be treated as no deviation.

Place :

Date :

Name & Designation of Authorized Person

Signature :

Stamp

**APPENDIX 5
PRICE BID**

SL No	Description of Items/Scope of Work	Quantity	Unit	Unit Rate excluding GST (Rs)	Total Amount excluding GST (Rs)	GST (%)	Total Amount including GST (Rs)
Fire Alarm System Equipment : AUTRONICA							
1	Control Panel-AUTROPRIME BC-250 W BS-210	1	No				
2	MCP Weather Proof(BF-510WP-H) with Gland Nut M20x 1.5 Polymide(2)	1	No				
3	Glands-Euro-Top M20L Gland 6-12 Grey	2	Nos				
4	MCP W-Manual Call Point Normal Current(BF-300V2)	1	No				
5	Detector-V-430/BH300	1	No				
6	Detector Base	1	No				
7	Detector-V-430/BH300	1	No				
8	Detector Base	1	No				
9	Conduit Box	1	No				
10	Detector-V-430/BD300	1	No				
11	Detector Base	1	No				
12	Conduit Box BWP - 100	1	No				
13	Sounder/flasher-Alarm Sounder Flasher Red Flashni	1	No				
14	Freight Charges, if any	1	LS				
15	Commissioning Support-Online or Offline	1	day				

Grand Total Amount including GST (Rs) :

Grand Total Amount including GST in Words:

Note:
1) Bidder must quote for all the line items.
2) Lowest bidder shall be identified based on overall L1 basis

Authorized Signatory:

Name:

Designation:

Signature:

ANNEXURE I
TECHNICAL SPECIFICATION

Heat detector with SelfVerify – BD-300

Interactive fire detection systems
Product datasheet

Features

- Interactive
- Plug-in detector head
- Heat detector intended for use in dry areas
- Short circuit isolator in each detector
- Conforms to EMC directive
- Comprises a built-in alarm indicator (LED)
- Automatic addressing
- Proven technology
- Configurable to class A1, A1R, A2S, B, C
- The BD-300 is not influenced by dust, humidity, exhaust gases, or electro-magnetic fields, such as radio transmitters, cellular phones, etc.
- EN 54-5/EN 54-17
- Designed to meet the requirement of the major maritime classification societies

Applications

BD-300 is a point heat detector for detection of rise in ambient temperature caused by a fire. The detector is designed for use with Autronica's interactive fire alarm systems. The SelfVerify function ensures the highest grade of reliability. All units comprising this function are automatically tested with a calibrated test once every 24 hours.

BD-300 is often used in areas where the environment is likely to produce false/unwanted alarms from smoke detectors such as:

- Galleys
- Bathrooms
- Kitchens
- Boiler rooms
- Workshops, etc.

Principle

Temperature measurement by means of a thermistor for registration and reading of temperature at the detector point. Alarm at temperature according to configured class (Ref. table 1).

SelfVerify: The detector's ability to initiate alarm at correct temperature is regularly checked.



Versions

- BD-200* Heat detector without SelfVerify.
- BD-300 Heat detector with SelfVerify.
- BD-500* Heat detector with SelfVerify, environmentally protected.
- BD-500/Ex* Heat detector with SelfVerify, EExia-version for use in all zones.

* See separate data sheet.

Technical specifications	
Weight	140 g
Materials	PC/ABS
Colour	White
Sensitivity	Ref. table 1
Voltage	10-27 VDC
Current consumption Stand by:	< 0,3mA
External alarm indicator:	6mA
CPD certificate	1134-CPD-018
Degree of protection	IP44D
Working temperature	-20 - +80°C
Storage temperature	-55 - +80°C
Max. application	Ref. table 1
Humidity (non condensing)	Max. 95%
Maintenance	None
Service	Replace if faulty
Approvals	See web site



Dimensions/Connections

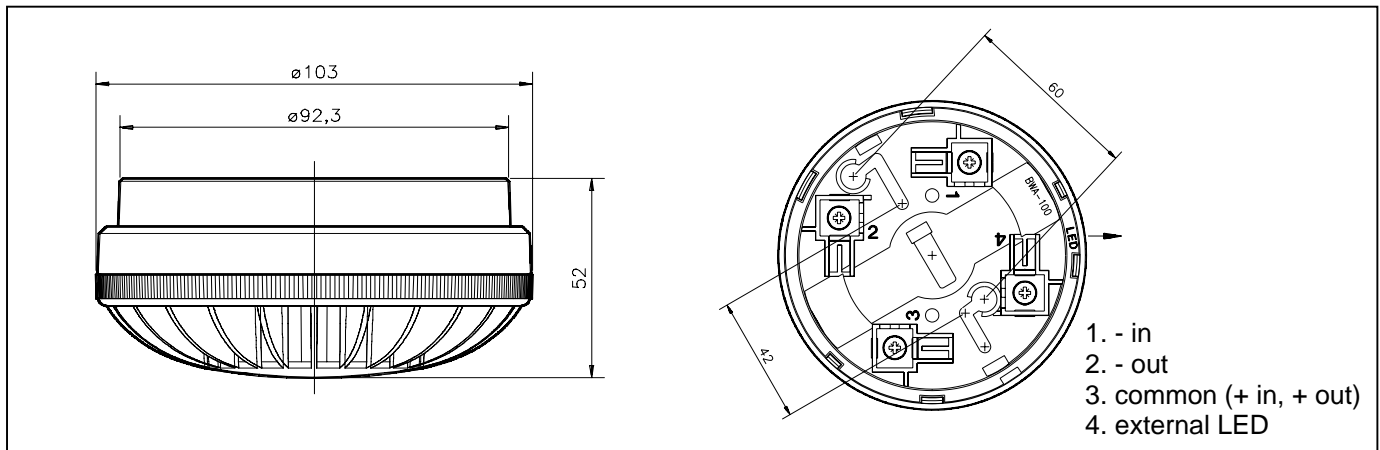

Use of LED output

When LED or other equipment is connected to the LED output, a varistor - Siemens SIOVS07K25 (39V) - Autronica part. no. 116-8464-003.5039, is required between terminals 1 and 4 in base.

The LED is connected between terminals 3 and 4, terminal 3 being the positive terminal.

Table 1

Detector class	Typical application temperature °C	Maximum application temperature °C	Minimum static response temperature °C	Maximum static response temperature °C
A1	25	50	54	65
A1R*	5	50	54	65
A2S*	25	50	54	70
B	40	65	69	85
C	55	80	84	100

* R= Rate of rise.

* S= (Slow) Does not respond below the minimum static response temperature.

Note: The detector may give prewarning on a temperature below the max. application temperature.

Part number	Description
116-BWA-100	Detector base
116-BDH-300	Detector head
116-BWP-100/20	Optional conduit box for M20 glands
116-BWP-100/25	Optional conduit box for M25 glands
116-BBR-52	Optional audible indicator – SmartBuzzer

AUTRONICA FIRE AND SECURITY AS

Head office, Trondheim, Norway Tel: +47 73 58 25 00, fax: +47 73 58 25 01, e-mail: info@autronicafire.no
 Oil and Gas division, Stavanger, Norway Tel: +47 51 84 09 00, fax: +47 51 84 09 99
 Maritime division, Spikkestad, Norway Tel: +47 31 29 55 00, fax: +47 31 29 55 01

Visit Autronica Fire and Security AS' website: www.autronicafire.com

MANUAL CALL POINT W/SELFVERIFY - BF-300V2

Interactive fire detection systems
Product Datasheet

Features

- Maximum 3-second response time
- Comprises a built-in indicator (LED)
- Can be tested by means of a special test key
- With SelfVerify function for reduced maintenance/testing and increased reliability
- Short-circuit isolator in each call point
- Automatic addressing
- Designed to meet the requirement of the major maritime classification societies
- Approved according to EN 54-11 and EN 54-17 for indoor applications



Description / Application

BF-300V2 is a manual call point for indoor use. The call point is designed for use with Autronica's interactive fire detection systems, and comprises the SelfVerify function. This function ensures the highest grade of reliability and the lowest degree of manual testing because all units comprising this function are automatically self-tested once every 24 hours.

The call point must be installed according to local regulations, which normally means along escape routes, landings and exits.

Operating method

- Press white plastic element. Resettable by means of dedicated test key.
- Optional: Break glass element. Resettable by mounting new glass element.

SelfVerify: the call point's ability to initiate alarm is regularly checked.

Versions

- BF-300V2
Manual call point with SelfVerify - standard version
 - BF-510WP-H*
Manual call point with SelfVerify, weatherproof – high current version
- *see separate datasheet

Product Name	Part number	Description
BF-300V2	116-BF-300V2	Manual call point with SelfVerify. Standard version
Accessories		
	116-4860-011.0100	Polycarbonate cover
	116-CXBZ	BEZEL
	116-BFG-3	Glass element
Spares		
	116-4860-011.0025	Spare Call Point

Technical specifications	
Weight	160 g
Material	ABS FR/PC
Colour	Red
Voltage	16 – 26 VDC
Current consumption	
Stand by:	0,3 mA
Alarm (LED):	6 mA
Maximum current on detection loop	Standard version 200 mA
CPD certificate	0333-CPD-075247
Degree of protection	IP44D with cover IP42D without cover
Working temperature	- 25 to + 70°C
Storage temperature	- 55 to + 70°C
Humidity (non-condensing)	Max. 95% RH
Service	Replace if faulty
Approvals	See website
Cable wire	Maximum 2,5 mm ²

Connections

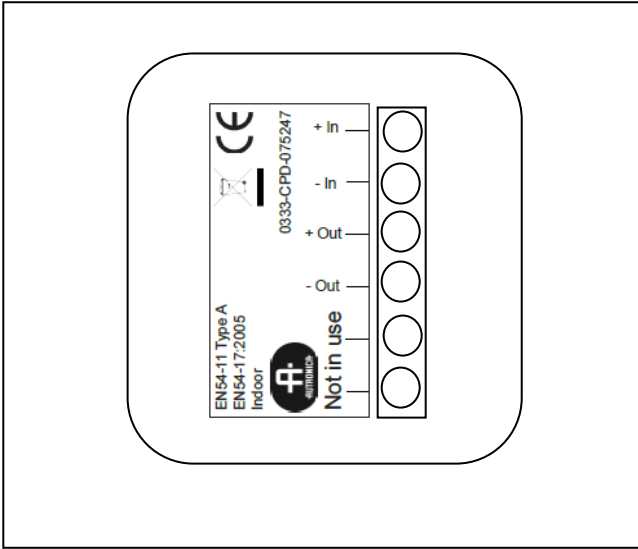

Dimension Drawing

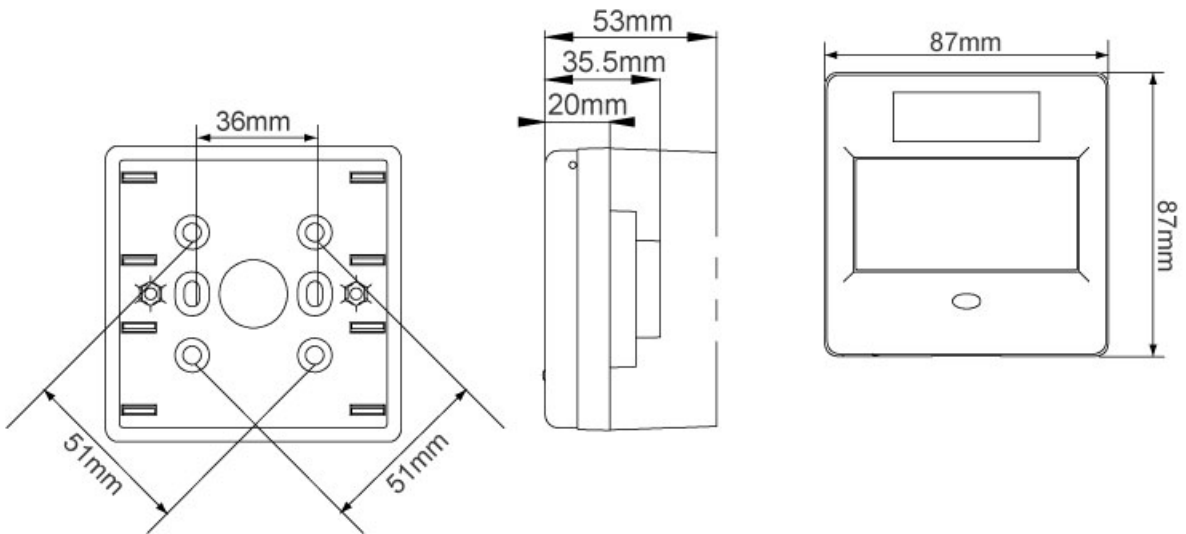

MANUAL CALL POINT W/SELFVERIFY, WEATHERPROOF - BF-510WP-H

Interactive fire detection systems Product Datasheet

Features

- For outdoor use
- Weatherproof
- Degree of protection: IP52 (66)
- With SelfVerify function for reduced maintenance/testing and increased reliability
- Short-circuit isolator in each unit
- Maximum 3-second response time
- Automatic addressing
- Designed to meet the requirement of the major maritime classification societies
- Approved according to EN 54-11 and EN 54-17

Description / Application

BF-510WP-H is a manual call point for outdoor use. The call point has been designed for use with Autronica's interactive fire detection systems, and it comprises the SelfVerify function. This function ensures the highest grade of reliability and the lowest degree of manual testing, because all units comprising this function are automatically self-tested once every 24 hours.

The high IP degree of the enclosure makes the call point suitable for outdoor applications.

The call point must be installed according to local regulations, which normally means along escape routes, landings and exits.

Operating method

- Press white plastic element. Resettable by means of dedicated test key.
- Optional: Break glass element. Resettable by mounting new glass element.

SelfVerify: the call point's ability to initiate alarm is regularly checked.



Installation

The back box is provided with three knockouts for M20 cable glands, two at the top and one at the bottom.

Versions

- BF-300V2*
Manual call point with SelfVerify - standard version
- BF-510WP-H
Manual call point with SelfVerify, weatherproof – high current version
- BF-510WP-HM
Manual call point with SelfVerify, weatherproof – high current version for maritime application

*see separate datasheet

Product Name	Part number	Description
BF-510WP-H	116-BF-510WP-H	Manual call point with SelfVerify. High current, weatherproof
	116-BF-510WP-HM	Manual call point with M20 PG16 cable glands and robust mounting plate pre-mounted
Accessories		
	116-4860-011.0100	Polycarbonate cover (IP66)
	116-6571-011.1920	Cable gland M20x1,5
	116-6531-006.1920	Gland back nut M20x1,5
	116-BFG-3	Glass element

Technical specifications	
Weight	200 g
Material	ABS
Colour	Red
Voltage	16 – 26 VDC
Current consumption	
Stand by:	0,3mA
Maximum current on detection loop	400mA
Environm. requirement	EN 54
CPD certificate	0333-CPD-075245
Degree of protection	IP66 with cover IP52 without cover
Working temperature	- 40 to + 70 °C
Storage temperature	- 55 to + 70 °C
Cable inlets	3 x M20
Service	Replace if faulty
Approvals	www.autronicafire.com

Dimensions

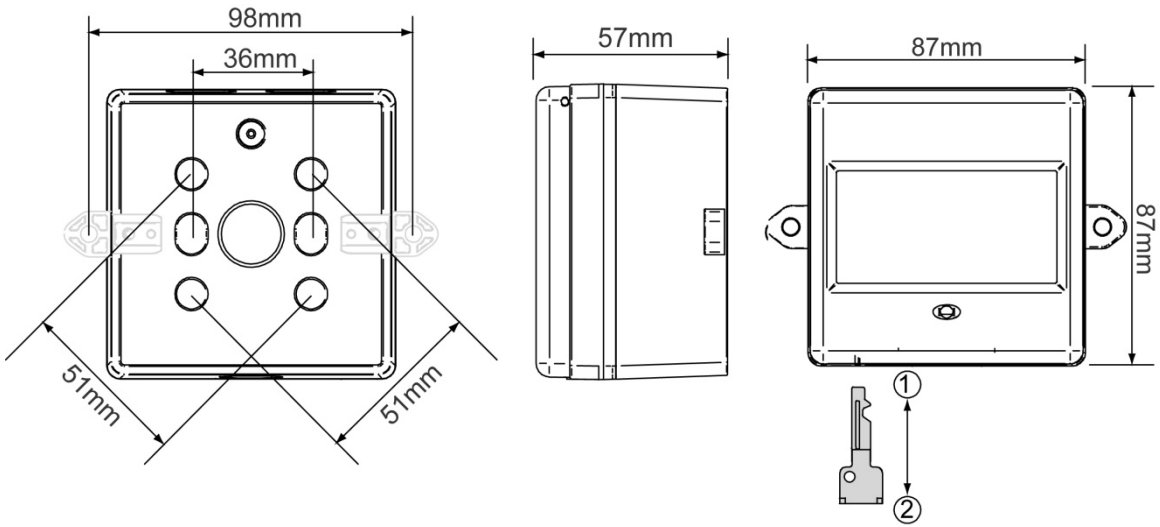

Connections

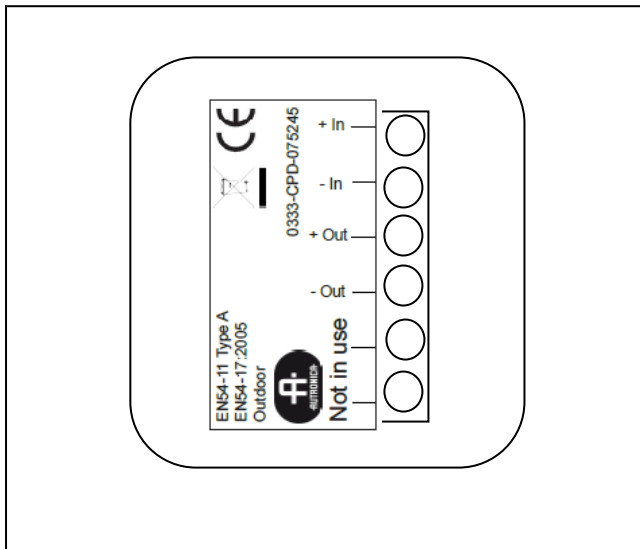

Optical smoke detector - BH-300

Interactive fire detection systems
Product datasheet

Features

- Interactive
- Different sensitivity settings possible
- Comprises the DYFI+ adaptive and self learning functions
- SelfVerify functions for reduced maintenance/testing and increased reliability
- Detection of visible smoke
- Built-in thermistor for reading of temperature at the detector point
- Short circuit isolator in each detector
- Comprises a built-in alarm indicator (LED)
- Automatic addressing
- Proven technology
- Immune to electromagnetic disturbance
- EN 54-7/EN 54-17
- Designed to meet the requirement of the major maritime classification societies

Applications

BH-300 is a point smoke detector for detection of combustion gases mainly consisting of visible particles. The detector has a built in thermistor and is designed for use with Autronica's interactive fire detection systems, which can provide temperature information from the detector point. The SelfVerify function ensures the highest grade of reliability because all units comprising this function are tested with a calibrated test once every 24 hours.

The *DYFI+* intelligence combined with the SelfVerify function makes this detector the obvious choice for demanding applications such as industrial, maritime and offshore installations.

Principle

Photoelectric, operating on the light scatter principle.

SelfVerify: The detectors ability to initiate alarm at correct amount of smoke is regularly checked.



Versions

- BH-200 Smoke detector without SelfVerify
- BH-300* Smoke detector with SelfVerify
- BH-500* Smoke detector with SelfVerify, environmentally protected
- BH-500/S* Smoke detector with SelfVerify, environmentally protected, with extra high sensitivity
- BH-500/Ex* Smoke detector with SelfVerify, EExia-version for use in all zones
- BH-500/S/Ex Smoke detector with SelfVerify, EExia-version for use in all zones, with extra high sensitivity
- BH-500/N Smoke detector with SelfVerify, EExn-version for use in zone 2 only
- BH-500/S/N Smoke detector with SelfVerify, and extra high sensitivity, EExn version for use in zone 2 only

* See separate data sheet.

Table 1 – Performance classes

Performance class	Typical application
Clean	Computer rooms
Normal	Offices
Normal 2	Restaurants
Industry	Workshops



Technical specifications	
Weight	150 g
Materials	PC/ABS
Colour	White
Sensitivity	Ref. Table 1
Voltage	10 – 27 VDC
Current consumption Stand by: External alarm indicator	< 0,3mA 6mA
CPD certificate	1134-CPD-016
Degree of protection	IP44D
Working temperature	- 20 - + 70°C
Humidity (non condensing)	Max. 95% RH
Maintenance	None
Service	Replace if faulty
Approvals	See web site

Dimensions/Connections

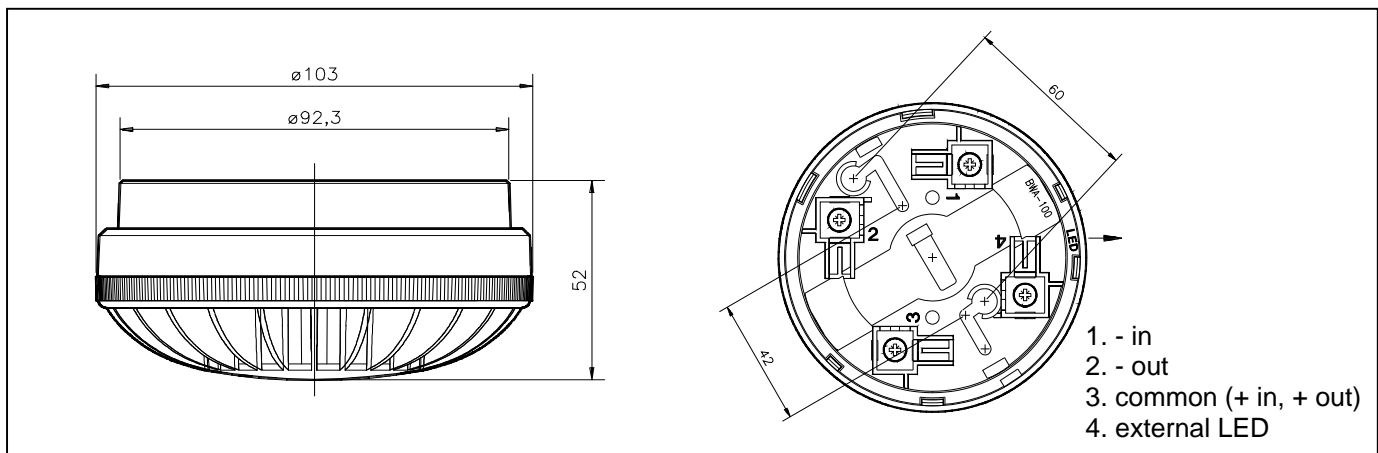

Use of LED output

When LED or other equipment is connected to the LED output, a varistor - Siemens SIOVS07K25 (39V) - Autronica part. no. 116-8464-003.5039, is required between terminals 1 and 4 in base. The LED is connected between terminals 3 and 4, terminal 3 being the positive terminal.

Part number	Description
116-BWA-100	Detector base
116-BHH-300	Detector head
116-BWP-100/20	Optional conduit box for M20 glands
116-BWP-100/25	Optional conduit box for M25 glands
116-BBR-52	Optional audible indicator – SmartBuzzer

AUTRONICA FIRE AND SECURITY AS

Head office, Trondheim, Norway Tel: +47 73 58 25 00, fax: +47 73 58 25 01, e-mail: info@autronicafire.no
 Oil and Gas division, Stavanger, Norway Tel: +47 51 84 09 00, fax: +47 51 84 09 99
 Maritime division, Spikkestad, Norway Tel: +47 31 29 55 00, fax: +47 31 29 55 01

Visit Autronica Fire and Security AS' website: www.autronicafire.com

FIRE ALARM CONTROL PANEL BS-200M

Autroprime interactive fire detection system Product Datasheet

Features

- SelfVerify-function for automatic testing of detectors
- Automatic setup
- Automatic addressing of detectors
- Four loops
- Built in changeover for primary/emergency mains power
- USB for data transfer to/from memory stick.
- User-friendly display and operator controls
- Back-lit operating buttons. Text display suitable for nighttime operation
- Surface mounting. The integrated panel can be mounted separately in a 19" rack or console
- Designed to meet EN 54 and SOLAS requirements, MED ("wheel-mark") and CPD certified
- Complies with environmental conditions of IEC-721-3-3 class 3k5
- Output to VDR and Modbus

Applications/Description

The BS-200M is an integrated Fire Alarm Control Panel for small-to-medium-sized installations. The panel is specifically designed for use in maritime applications and meets the SOLAS requirements. The panel serves as a stand-alone panel. A maximum of 8 additional panels can be freely mixed and connected to the Fire Alarm Control Panel via the RS-485 Panel Bus, including Repeater Panels BS-211, Information Panels BV-210, Fire Brigade Panels BU-210 and Mimic Drivers BUR-200.

All alarm handling and system features can be configured, controlled and monitored from the panel.

The panel can accommodate up to a maximum of four detection loops. The loops support most of AutoSafe detectors, several types of I/O devices for monitored outputs, open collector outputs, galvanic isolated inputs and monitored inputs. It has a 5A power module for battery charging.

The panel is menu operated on a 8-line display, with 40 characters per line.

The Operator Panel (BS-210), which is an integrated part of the BS-200M panel, can also be mounted separately outside the cabinet.

Indicators

- 8 x 40-character alphanumeric display
- Alarm, More Alarms, Pre-Alarm, Remote Call, Remote Call Response, Fault, Disabled Function, Supervisory Condition, Test Condition, System Fault, Power, Delayed Activation, Annunciator Fault, Remote Call Fault, Annunciator Disabled, Remote Call Disabled, Reduced Detection
- Internal buzzer



Operator Controls

- More Events, Mute, Silence, Reset, Block, Activate Outputs
- Keypad with alphanumeric characters and navigational functions (Cancel/Back, Enter, directional keys (arrow up/down and left/right), Function and Select (MultiSelect) key)
- Back-lit buttons and text
- Fireman's key

Capacity, maximum number of:	
Detection loops per fire alarm control panel	4
Loop units per detection loop	127
Loop units per branch on a detection loop	32
Loop sounders per detection loop	40
Fire Brigade/Information/Repeater Panels and Mimic Drivers per fire alarm control panel	8
Serial ports	1
Ethernet	1
USB host ports	2
Languages supported	15
Relay outputs	2
Monitored outputs (24 V)	2
Non-monitored outputs (OC)	2
Inputs	4



Technical specifications	
Dimensions (mm)	420 x 346 x 140
Weight	9 kg (excluding batteries)
Materials	Steel cabinet, ABS/PC moulded front
Mounting	Surface, flush or rack mounting
Protection class	IEC-529 / IP32
Operating temperature	-15°C to +70°C
Storage temperature	-40°C to +70°C
Humidity non-condensing	Maximum 95% RH
Power supply	115/230VAC 1,6/0,8A Frequency: 50/60Hz
Current consumption	250mA at 27VDC
Loops	4
Capacity – loop units	127 per loop
Batteries	2 x 12V = 24V (not included)
Communication	Built-in TCP/IP (Ethernet) for Modbus, Serial Port

Part number	Description
116-71211548	BS-200M Fire Alarm Panel, 110VAC / 230VAC
116-71211549	BS-200M Fire Alarm Panel, 230VAC with changeover relay
116-71211550	BS-200M Fire Alarm Panel, 110VAC with changeover relay

Factory set outputs:

(For functionality/configuration setup, see Installation Handbook)

- Relay no. 1: Activated at alarm / Off at Reset
- Relay no. 2: Activated at fault / Off at Reset
- Mon. output 1 and 2: Activated at alarm / 2 min. delay / Off at Silence

Additional outputs/inputs (no factory setting):

(For functionality/configuration setup, see Installation Handbook)

- Non-monitored outputs 1 and 2
- Monitored inputs 1 and 2
- Non-monitored inputs 1 and 2

Connections in detector base 116-BWA-100

Part number 116-BWA-100

Made in Norway

CONNECTIONS IN DETECTOR BASE (SOCKET) BWA-100 TILKOBLING I DETEKTORSOKKEL BWA-100

AutoSafe system AutoSafe system

- 1 = - NEGATIVE IN
MINUS INN
- 2 = - NEGATIVE OUT
MINUS UT
- 3 = + POSITIVE COMMON
FELLES PLUSS
- 4 = OUTPUT EXT.LED
UTGANG EXST. LED

Conventional system Konvensjonelt system

- 1 = - NEGATIVE COMMON
FELLES MINUS
- 2 = + POSITIVE IN
PLUSS INN
- 3 = POSITIVE OUT
PLUSS UT
- 4 = OUTPUT EXT.IND. (T)
UTGANG EKST. IND.(T)

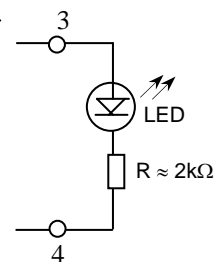
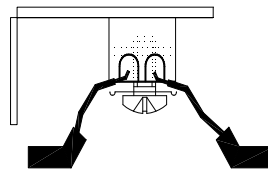
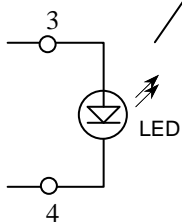

NB! Figure shows connections to AutoSafe System.

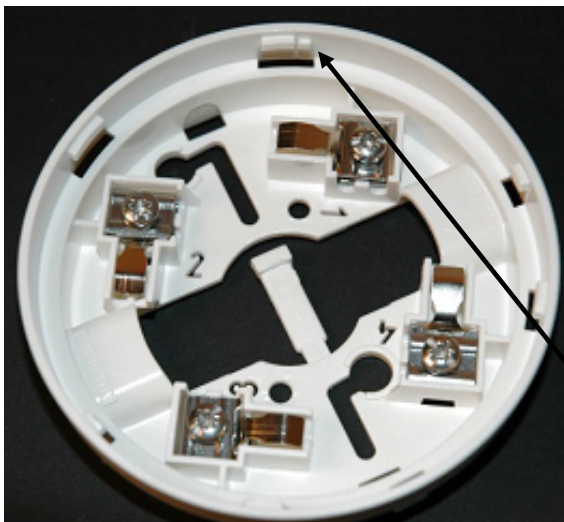

NOTE!

Tamper- and vibration-proof installation.

On Maritime, Offshore and other installations where vibration can be expected, the detector head should be locked in place in order to secure proper electrical connection and to prevent damage. This is obtained by removing the locking nub in the detector base with a pair of cutting nippers or similar.

Inngreps- og vibrasjonssikker installasjon.

Ved maritime, offshore og andre installasjoner hvor vibrasjoner forventes, må detektorhodet låses for å sikre korrekt elektrisk forbindelse og for å forhindre skade. Dette oppnås ved å fjerne fjærstopperen i detektorbasen med avbiter eller lignende.

Locking nub / Fjærstopper

AUTRONICA FIRE AND SECURITY AS

Fire and Security, Trondheim, Norway Phone: +47 73 58 25 00, Fax: 73 58 25 01

Oil and Gas, Stavanger, Norway Phone: +47 51 84 09 00, Fax: +47 51 84 09 99

Maritime division, Spikkestad, Norway Phone: +47 31 29 55 00, Fax: +47 31 29 55 01

Visit Autronica Fire and Security AS' website: www.autronicafire.com



Raccordement des socle de detecteur 116-BWA-100

116-BWA-100

Made in Norway

RACCORDEMENT DES SOCLE DE DETECTEUR BWA-100 CONNECTIONS IN DETECTOR BASE (SOCKET) BWA-100

AutoSafe system *Boucle adressée AutoSafe*

- 1 = - NEGATIVE IN
1= *ENTRÉE (-)*
- 2 = - NEGATIVE OUT
2= *SORTIE (-)*
- 3 = + POSITIVE COMMON
3= *COMMUN (+)*
- 4 = OUTPUT EXT.LED
4= *INDICATEUR D'ACTION*

Conventional system *Boucle conventionnelle*

- 1 = - NEGATIVE COMMON
1= - *COMMUN (-)*
- 2 = + POSITIVE IN
2= *ENTRÉE (+)*
- 3 = POSITIVE OUT
3= *SORTIE (+)*
- 4 = OUTPUT EXT.IND. (T)
4= *INDICATEUR D'ACTION (T)*

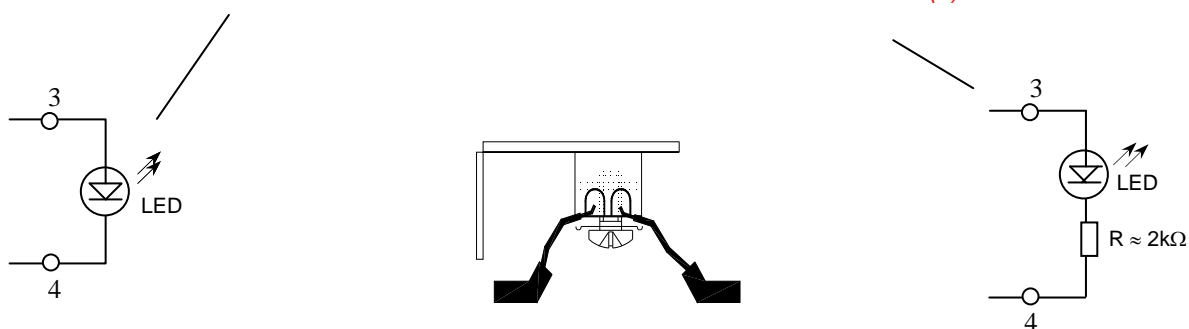

NB! Figure shows connections to AutoSafe System.

Note : La figure illustre le raccordement sur une boucle adressée AutoSafe

NOTE!

Tamper- and vibration-proof installation.

On Maritime, Offshore and other installations where vibration can be expected, the detector head should be locked in place in order to secure proper electrical connection and to prevent damage. This is obtained by removing the locking nub in the detector base with a pair of cutting nippers or similar.

NOTE !

Système de blocage

En milieu maritime, offshore ou dans certaines installations ou des vibrations sont attendues, les detecteurs doivent être bloqué en position afin de garantir les connexions électriques et prévenir tout dommage. Ceci est obtenu par la suppression de l'ergot de positionnement situé sur le socle à l'aide d'un outil de type cutter ou sicseau.

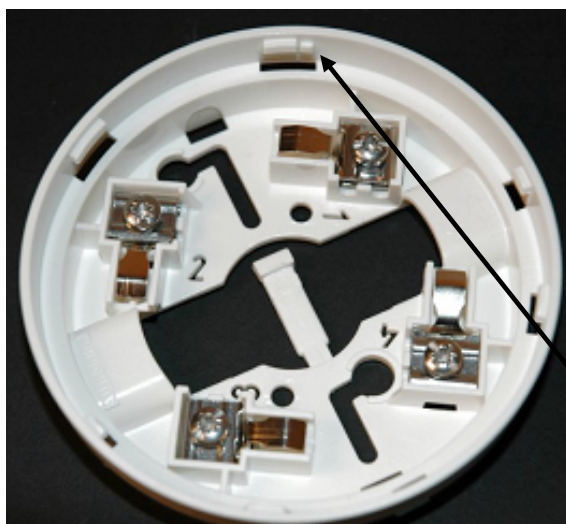

Locking nub

Ergot de positionnement

AUTRONICA FIRE AND SECURITY AS

Fire and Security, Trondheim, Norway Phone: +47 73 58 25 00, Fax: 73 58 25 01

Oil and Gas, Stavanger, Norway Phone: +47 51 84 09 00, Fax: +47 51 84 09 99

Maritime division, Spikkestad, Norway Phone: +47 31 29 55 00, Fax: +47 31 29 55 01

Visit Autronica Fire and Security AS' website: www.autronicafire.com



CONDUIT BOX - BWP-100

Interactive fire detection systems Product Datasheet

Features

- Designed to protect the connections to detectors in humid environments
- Easy to mount

Description

BWP-100 is a conduit box for installation of detectors in environments that may be humid/wet. The conduit box is designed for use with Autronica's interactive fire detection systems, to make the detector terminals dust and jet proof.

BWP-100 is suitable for use in environments such as engine rooms, workshops, storerooms, etc.

Terminal block with 3 terminals is mounted in the box. One more terminal block may be mounted if needed (optional).

Standard detector base BWA-100 is used for connecting and mounting the detector head.

Versions

- BWP-100/20
Standard version, four knockouts for mounting of M20 cable glands.
Two M20 cable glands (116-6571-011.1920) for 5 - 12 mm wires and two back nuts (116-6531-006.1920) are included with the unit.
- BWP-100/25
Offshore version, four holes, $\varnothing=25$ mm, for mounting of glands or blanks (not included with the unit).
Optional cable gland and nuts: for 13 - 18 mm wires or 17 mm wires

See part numbers listed on next page.



BWP-100/20



BWP-100/25

Part Number	Description
116-BWP-100/20	Conduit (Standard version) M20, cable diameter gland 5-12 mm
116-BWP-100/25	Conduit (Offshore version) 4 x M25 holes
Accessories:	
116-6370-008.0032	O-ring N674-70 for IP65
116-7354-040.0001	Spare terminal block with 3 terminals
116-6332-032.1925	Blind plug, M25EEXEIP67 GHG9601952
116-6571-011.1922	Gland PG16, 10-14 mm
116-6571-011.1926	Gland M25, 13-18 mm
116-6571-011.1927	Gland M25, 9-17 mm
116-6531-006.1925	Back nut for gland M25
116-6571-011.1920	Gland M20, for cable 5-12 mm + 116-6531-006.1920 Back nut for gland M20

Technical Specification	
Weight	116-BWP-100/20: 140g 116-BWP-100/25: 172g
Material	Self-extinguishing polycarbonate
Colour	RAL 9010 White
Degree of protection	IP65 (IEC 529) with detector and O-ring (option) IP55 with detector without O-ring
Maintenance	None

Dimensions

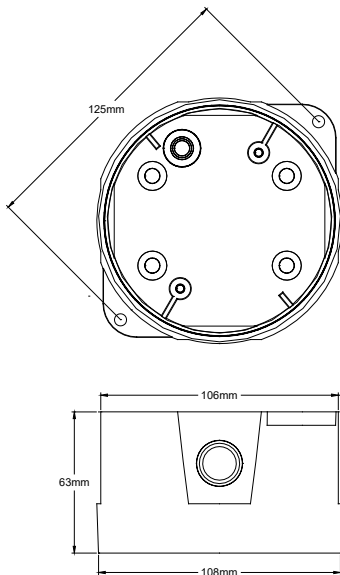

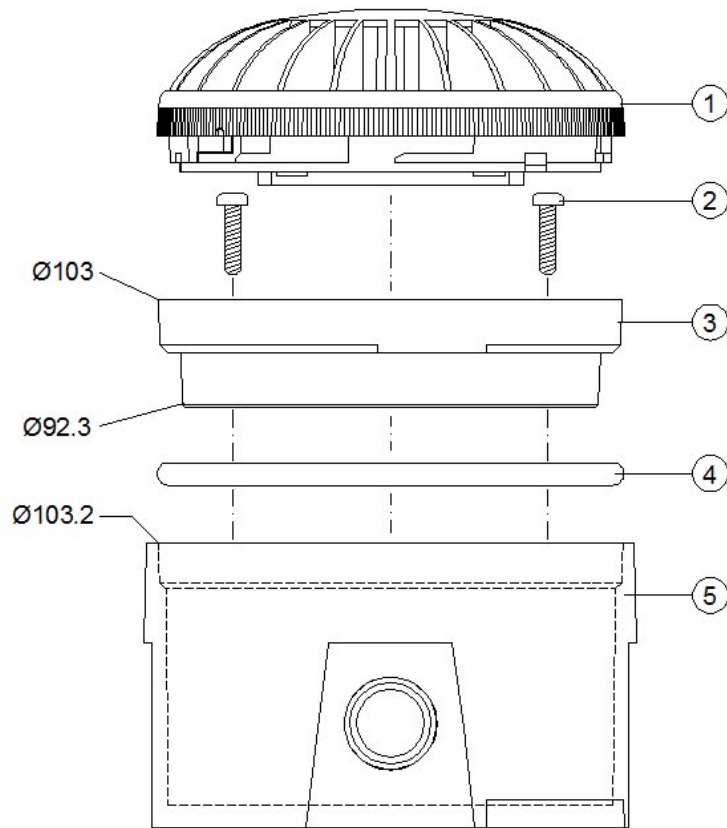
Assembly Drawing

- 1) Smoke/Heat Detector
- 2) Screws 3,5x16mm
- 3) Detector Base
- 4) O-ring N674-70
- 5) Conduit Box BWP-100/20

SOUNDER/BEACON – FLASHNI

Product Datasheet

Features

- Compact design
- Available with deep or shallow base for surface wiring
- IP65 protection with deep base
- High efficiency Fresnel lens for maximum light output
- Automatic sounder synchronization
- Volume control as standard
- Conform to CPD EN 54-3 and A1

Description

Providing an audio-visual warning, the Flashni combines the features of a Roshni electronic sounder with a fully integrated Xenon beacon. The result is an attractively designed unit for installation in internal or external locations where a combination of high sound output and visual indication is required.

Applications

- Retirement homes
- Noisy manufacturing areas

Dimensions

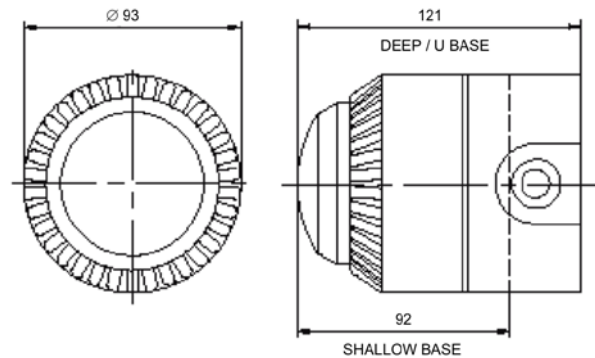

Part number	Description
116-7780-004.0001	Flashni, red, red lens, shallow base
116-7780-004.0002	Flashni, red, red lens, deep base
116-7780-004.0003	Flashni, white, blue lens, shallow base
116-7780-004.0004	Flashni, red, clear lens, shallow base
116-7780-004.0010	Flashni, red, blue lens, deep base



Technical specifications	
Operating voltage range	18 – 30 VDC
Current consumption	68mA at 24 VDC
Beacon	1W
Flash rate	60/min
Operating temperature	-10°C – +55°C
Construction	Lens: Polycarbonate Base: ABS
Ingress protection	Shallow base: IP54 Deep base: IP65*
Weight	Shallow base: 290 g Deep or U base: 325 g
Sound output	101dB/1m (tone 3)
Tones	Preset to tone 3 Other tones on request

* To obtain IP65, use suitable cable gland

